

MODEL	H(mm)	H1(mm)	M(mm)
T 5202	5.0	1.7	1.95
T 5202C	6.5	3.2	1.95

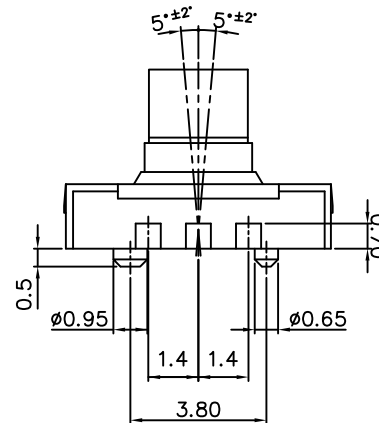

1. RATING : DC 12V 50mA
2. CIRCUIT : 1C-5P
3. TIMING : NON-SHORTING
4. TRAVEL : 4-Directional : 0.25mm
Center Push : 0.15mm
5. OPERATING FORCE : 4-Directional : 160 ± 50 gf
Center Push : 250 ± 50 gf
6. CONTACT RESISTANCE : 500m Ω MAX.
7. OPERATING LIFE : 200,000 CYCLES

* 5202N - Without Guide Bosses

	PART NO.	MODEL					Q'TY	MATERIAL	SPECIFICATION	TREATMENT	REFERENCE
TOLERANCE UNLESS OTHERWISE STATED(mm)						TRIGONOMETRY	UNIT m/m	SCALE $\frac{1}{1}$	USER	TACT SWITCH	
less than 10 _____ ±0.1						APPROVAL	CHECK	DESIGN	TITLE	T 5202 SERIES	
10~30 _____ ±0.2									DWG NO.	T 5202-0	
30~100 _____ ±0.3											
ANGLE _____ ±2°	MARK	DATE	APPR.	CHECK	DESIGN						